

HAFCO WOODMASTER

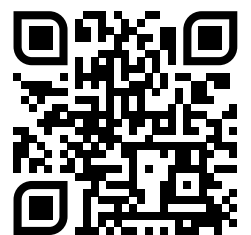

Edition : 2.0
Date: (01/26)

Instruction Manual

AIR FILTRATION UNIT AP-12

Order Code: (W326)

MACHINE DETAILS

MACHINE.	Two Stage Air Filtration Unit
MODEL NO.	AP-12
SERIAL NO.	
DATE OF MANF.	

Imported by

Australia



www.machineryhouse.com.au

New Zealand



www.machineryhouse.co.nz

NOTE:

This manual is only for your reference. At the time of the compiling of this manual every effort to be exact with the instructions, specifications, drawings, and photographs of the machine was taken. Owing to the continuous improvement of the HAFCO WOODMASTER machine, changes may be made at any time without obligation or notice. Please ensure the local voltage is the same as listed on the specification plate before operating any electric machine.

SAFETY SYMBOLS:

The purpose of safety symbols is to attract your attention to possible hazardous conditions

 **WARNING** Indicates a potentially hazardous situation causing injury or death.

 **CAUTION** Indicates an alert against unsafe practices.

Note: Used to alert the user to useful information

NOTE:

In order to see the type and model of the machine, please see the specification plate. Usually found on the back of the machine. See example (Fig.1)

Fig. 1

HAFCO WOODMASTER	
PRODUCT SPECIFICATIONS	
Model: AP-12	Voltage: 240V/50Hz
Capacity: 1044CFM	Motor: 0.15kW
Nett Weight: 29kg	FLC:1.6A
MFG Date:	
Serial No:	<input type="text"/>
Imported by www.machineryhouse.com.au	Made in China www.machineryhouse.co.nz

C O N T E N T S:

1.	GENERAL MACHINE INFORMATION	
1.1	Specifications	4
1.2	Accessories.....	4
1.3	Identification	5
2.	IMPORTANT INFORMATION	
2.1	General Safety Requirements	6
2.2	Additional Safety For AP-12	8
2.3	Electrical Requirements	8
3.	SETUP	
3.1	Placement	9
3.2	Unpacking.....	9
3.3	Mounting the Air Filter.....	9
4.	OPERATION	
4.1	Controls and Features.....	10
4.2	Turning The Unit ON & OFF	11
4.3	Changing Air Flow Speeds	11
4.4	Setting The Timer.....	11
5.	MAINTENANCE	
5.1	Troubleshooting	12
5.2	Cleaning The Filters	13
5.3	Fuse Replacement.....	14
5.4	Remote Battery Change	14
	SPARE PARTS	15

1.1 SPECIFICATIONS

Order Code	W326
MODEL	AP-12
Outer Filter	5 Microns
Inner Filter	1 Micron
Overall Dimensions (LxWxH)	610 x 7.70 x 350mm
Sound Rating @ 3ft (High Speed)	69dB
Sound Rating @ 3ft (Medium Speed)	67dB
Sound Rating @ 3ft (Low Speed)	62dB
Air Flow HIGH SPEED (C.F.M)	1044
Air Flow MEDIUM SPEED (C.F.M)	702
Air Flow LOW SPEED (C.F.M)	556
Motor (Watts/Hp)	150/0.2
Power	240V 1PH 50Hz
Timer Settings (hours)	1.2 and 4
Nett Weight (kg)	27

1.2 ACCESSORIES

Flange brackets for wall or ceiling mounting

Eye bolts for mounting to ceiling rafters

Rubber feet for placing unit on workbench



1.3 IDENTIFICATION

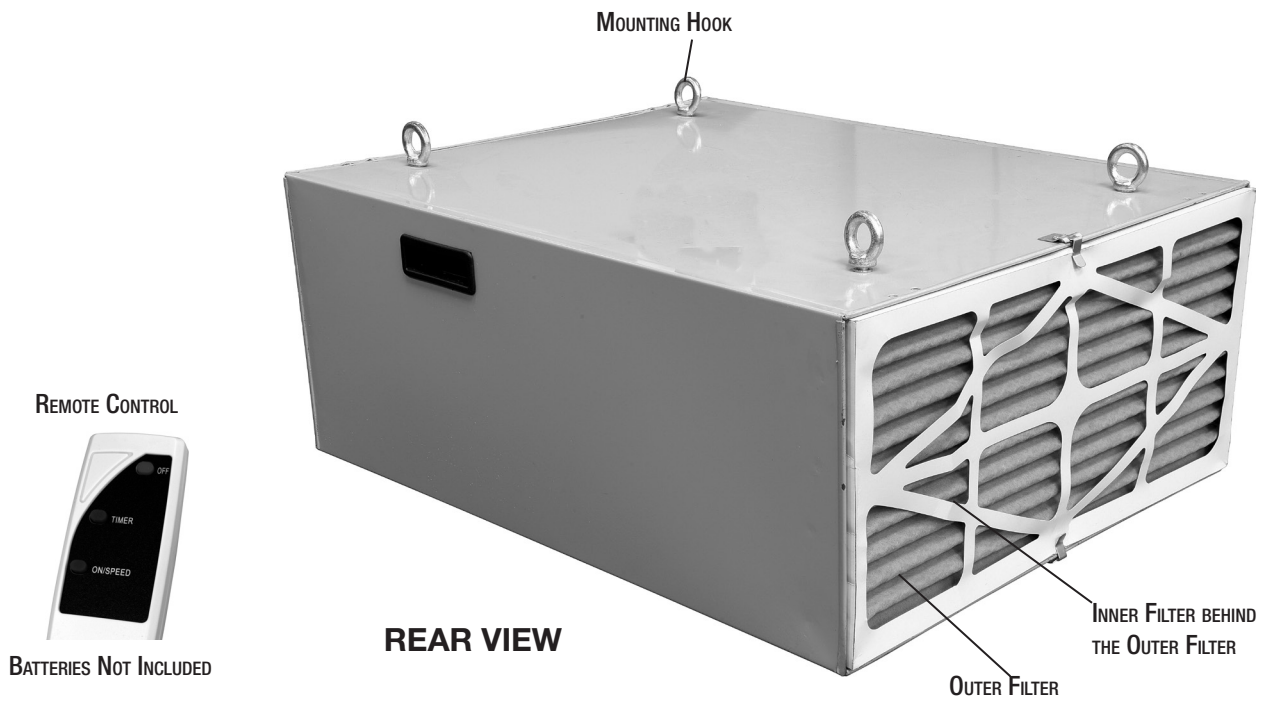
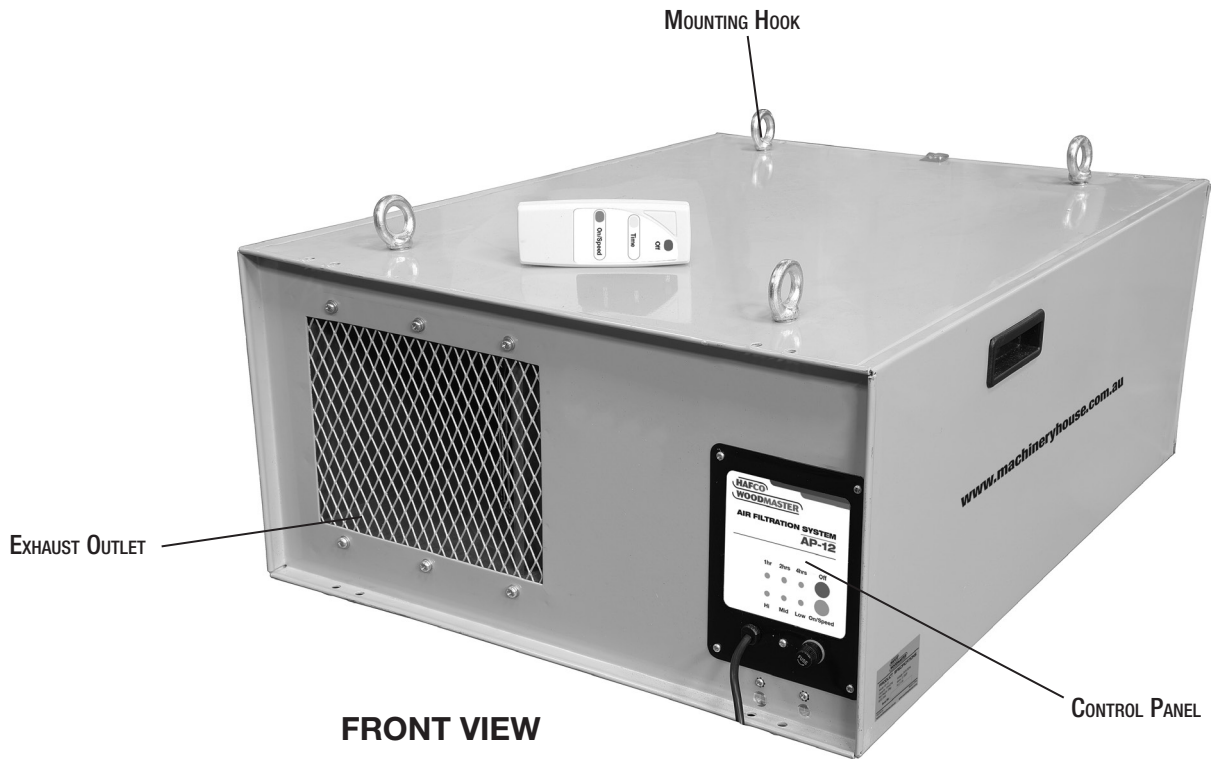

2. IMPORTANT INFORMATION

2.1 GENERAL SAFETY REQUIREMENTS

DO NOT use this machine unless you have read this manual or have been instructed in the use of this machine in its safe use and operation



WARNING

This manual provides safety instructions on the proper setup, operation, maintenance, and service of this machine. Save this manual, refer to it often, and use it to instruct other operators.

Failure to read, understand and follow the instructions in this manual may result in fire or serious personal injury—including amputation, electrocution, or death.

The owner of this machine is solely responsible for its safe use. This responsibility includes, but is not limited to proper installation in a safe environment, personnel training and authorization to use, proper inspection and maintenance, manual availability and comprehension of the application of the safety devices, integrity and the use of personal protective equipment.

The manufacturer will not be held liable for injury or property damage from negligence, improper training, machine modifications or misuse.

Exposure to the dust created by power sanding, sawing, grinding, drilling and other construction activities may cause serious and permanent respiratory or other injury, including silicosis (a serious lung disease), cancer, and death. Avoid breathing the dust and avoid prolonged contact with dust. Some examples of these chemicals are:



- Lead from lead-based paints.
- Crystalline silica from bricks, cement and other masonry products.
- Arsenic and chromium from chemically-treated timber.

Always operate tool in well ventilated area and provide for proper dust removal. Use a dust collection system along with an air filtration system whenever possible. Always use properly fitting approved respiratory protection appropriate for the dust exposure, and wash exposed areas with soap and water.



Safety glasses must be worn at all times in work areas. Earmuffs should be worn if the work area is noisy.



Sturdy footwear must be worn at all times in work areas.



Gloves should NOT be worn when operating this machine.



Long and loose hair must be contained with a net or under a hat.

2.1 GENERAL SAFETY REQUIREMENTS Cont.

DISCONNECT POWER FIRST. If using power, always disconnect the machine from power supply before making adjustments, or servicing the machine. This prevents any risk of injury from unintended startup or contact with live wires.

WEARING PROPER APPAREL. Do not wear clothing, apparel or jewellery that can become entangled in moving parts. Always tie back or cover long hair. Wear non-slip footwear to avoid accidental slips, which could cause loss of operating control.

HEARING PROTECTION. Always wear hearing protection when operating or observing loud machinery. Extended exposure to this noise without hearing protection can cause permanent hearing loss.

REMOVE ADJUSTING TOOLS. Tools left on machinery can become dangerous projectiles upon startup. Never leave hex keys, wrenches, or any other tools on machine. Always verify removal before starting!

USE CORRECT TOOL FOR THE JOB. Only use this tool for its intended purpose. Do not force the machine or its attachments to do a job for which they were not designed. Never make unapproved modifications. Modifying the machine or using it differently than intended may result in malfunction or mechanical failure that can lead to personal injury or death!

AWKWARD POSITIONS. Keep proper footing and balance at all times when operating machine. Do not overreach! Avoid awkward hand positions that make operating control difficult. This could increase the risk of accidental injury

GUARDS & COVERS. Guards and covers reduce accidental contact with moving parts or flying debris. Make sure they are properly installed, undamaged, and working correctly.

TRAINED OPERATORS ONLY. Only allow trained or supervised people to use this machine. When the machine is not being used, disconnect the power to the machine to prevent unauthorized use—especially around children. Make the workshop safe.

FORCING MACHINERY. Do not force the machine. It will do the job safer and better at the rate for which it was designed.

NEVER STAND ON MACHINE. Serious injury may occur if the machine is tipped or if the cutting tool is unintentionally contacted.

STABLE MACHINE. Unexpected movement during operation greatly increases risk of injury or loss of control. Before starting, verify the machine is stable and if using a mobile base it is locked in position.

UNATTENDED OPERATION. To reduce the risk of accidental injury, turn the machine OFF and ensure all moving parts have completely stopped before walking away. Never leave the machine running while unattended.

MAINTAIN WITH CARE. Follow all the maintenance instructions and lubrication schedules to keep the machine in good working condition.

A machine that is improperly maintained could malfunction, leading to serious personal injury or death.

CHECK DAMAGED PARTS. Regularly inspect the machine for any condition that may affect the safe operation. Immediately repair or replace damaged or parts that are incorrectly fitted before operating.

CHILDREN & BYSTANDERS. Keep children and bystanders at a safe distance from the work area. Stop using machine if they become a distraction.



WARNING!

Before operating any machine, take time to read and understand all safety signs and symbols. If not understood seek explanation from your supervisor or an experienced operator.

2.2 ADDITIONAL SAFETY REQUIREMENTS FOR AP-12

- ❑ Do not use the HAFCO/WOODMASTER Air Filtration System for anything other than wood dust. Materials such as liquids, metal shavings, metal dust, glass, plastic or rock particles could cause damage if they were to come in contact with any part of the machine.
- ❑ Never place hands near the inlet grill of the machine.
- ❑ Always make sure the machine is OFF and unplugged when working near the inlet.
- ❑ To reduce the risk of injury unplug the air filter from the power source and ensure the fan is stationary before servicing or changing filters.
- ❑ If ceiling mounted, the bottom of air filter must be at least 2.13M above the floor.
- ❑ If ceiling mounted, mounts must be anchored to building structure which will support a minimum of 45 kg. Never mount to surfaces such as dry wall or false ceiling grids, etc.
- ❑ To reduce the risk of electrical shock, do not expose air filter to water or rain.
- ❑ Never duct a machine directly into the air filter.
- ❑ To avoid a potentially dangerous situation, do not use this equipment to filter volatile fumes or smoke. This air filter is designed and intended for the filtration of airborne wood dust only. It is neither designed nor intended for any other purpose whatsoever.
- ❑ Failure to comply may result in serious injury and could cause property damage.

2.3 ELECTRICAL REQUIREMENTS.

- ❑ Should there be a malfunction or breakdown, earthing provides a path of least resistance for electric current to reduce the risk of electric shock. This machine is equipped with an electric lead having an earthing conductor and an earthing plug. The plug must be plugged into a matching outlet that is properly installed and earthed in accordance with all local regulations. (Fig. 2)
 - ❑ Do not modify the plug provided. If it will not fit the outlet, have the proper outlet installed by a qualified electrician.
 - ❑ The improper connection of the earth pin on the plug can result in a risk of electric shock. The plug pin, has insulation having an outer surface that is green, with or without yellow stripes. The repair or replacement of the electric lead or plug must be carried out by a qualified electrician.
- ❑ The power supply required is a 10 amp 240 Volt single phase 50Hz. The full load current is 1.5 amp.

⚠ WARNING *Equipment must be earthed while it is used to protect the operator from electrical shock. The mains connection and any extension leads used must comply with the local regulations.*

The mains power supply must comply with the information on the machine's specification label. Any electrical work must be done by a qualified electrician



3. SETUP

3.1 PLACEMENT

- ❑ The air filter unit does not require much assembly, but consideration should be given to how and where the unit is to be placed. This unit is specifically designed to filter non-metallic dust, when it is generated throughout the work area, and return it as clean air.
- ❑ The unit operates at its optimum when it is hung from the ceiling, located away from corners of the room or near any heating or cooling vents. A minimum ceiling height of 2.3 metres is required. The unit can also operate when placed on a bench or a cabinet. If it is to be used sitting on sawhorses, the air filtration unit needs to be secured in place.

3.2 UNPACKING

This machine was carefully packaged for safe transport. When unpacking, separate all enclosed items from packaging materials and inspect them for shipping damage. If items are damaged, please contact your distributor.

NOTE: Save all the packaging materials until you are completely satisfied with the machine and have resolved any issues with the distributor, or the shipping agent.

When unpacking, check to make sure that all parts shown on page 4 are included. If any parts are missing or broken, please contact your distributor.

3.3 MOUNTING THE AIR FILTER

The air filtration unit works best if it is hung from the ceiling.

To mount the air Filter from the ceiling;

1. Make sure the THE POWER PLUG IS NOT CONNECTED TO THE SOCKET
2. Remove all packing from inside of the unit by removing the outer filter and inner filters.
3. Remove the four screws from the top of the cabinet and replace with the four eye bolts supplied to hang the unit. Make sure the eye bolts are tightened against the cabinet top. (Fig 3.)
4. Drill holes into the beams and securely mount the four mounting brackets provided into the ceiling and attach the air filtration system to the ceiling. with suitable chains. (not supplied)



CAUTION!

A prepared list of safety guidelines can never be complete. Every workshop environment is different. Always consider Safety first, as it applies to your individual working conditions. Use this machine and other machinery with caution and respect. Failure to do so could result in serious Personal injury, damage to the equipment, or poor work results.

4. OPERATION

4.1 CONTROLS & FEATURES

Remote Control: The remote control enables you to operate the unit up to a range of 20 metres

TIMER BUTTON (Fig. 4) controls the three different timer settings. Press the Time button once for 1 hours. with automatic shut off, twice for 2 hours with automatic shut off, or three times for 4 hours with automatic shut off.

1H will light up on the back of the unit by pressing the time button once. (Fig.5) The machine will operate for 1 hour then automatically shut off.

2H will light up on the back of the unit by pressing the time button twice. (Fig.5) The machine will operate for 2 hours then automatically shut off.

4H will light up on the back of the unit by pressing the time button three times. (Fig.5) The machine will operate for 4 hours then automatically shut off.

ON/SPEED button (Fig. 4) Turns unit ON and controls the three different fan settings, LO, MID and HI. There is also a on/speed button (Fig. 5) on the backside of this unit which controls the speed and turns the unit ON. Press the “On/Speed” button once for high power, twice for medium, and three times for low power.

OFF button (Fig. 4) turns the unit off. There is also a manual OFF button (Fig. 5) on the backside of the unit.

Fuse (Fig. 5) will blow in the case of overload. Replace with equivalent 5A fuse.

WARNING *Before servicing or changing filters, unplug the air cleaner from the power source and ensure the fan is stationary. Failure to comply may cause serious injury or damage to the machine.*



Fig. 4



Fig. 5



WARNING!

Before operating any machine, take time to read and understand all safety signs and symbols. If not understood seek explanation from your supervisor or an experienced operator.

4. OPERATION Cont.

4.2 TURNING THE UNIT ON & OFF

When the air filter is connected to power supply, press the ON SPEED button on the air filter control panel or on the remote control to turn the unit ON. (Fig. 6)

Note: The remote control communicates with the air filter using infrared and must be pointed directly at the air filter control panel to work properly.

The remote control enables you to operate the unit up to 20 metres. The red button is for remotely turning the unit OFF. The ON/Speed button is for turning the air filter ON and setting the fan speed.



Fig. 6

4.3 CHANGING AIR FLOW SPEEDS

The air filter can be set to operate in three air flow speeds 566 (LO), 702 (MED), and 1044 (HI) Cubic Feet per Minute air flow that is generated through the air filter.

To cycle through the available speeds, press the ON SPEED button on the control panel or remote control repeatedly. This will illuminate the corresponding lights on the control panel. (Fig. 7)

Repeatedly pressing the ON/SPEED button will cycle the unit through the fan speed 1, fan speed 2 and fan speed 3.

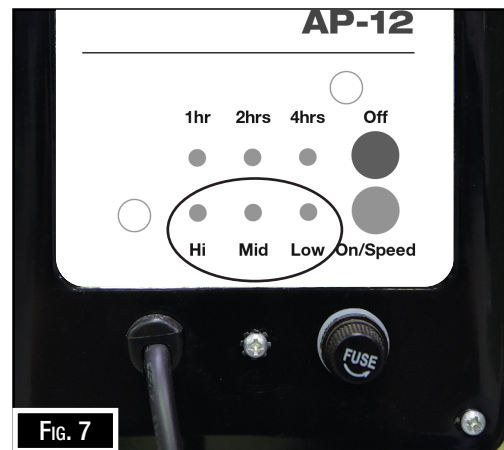

Fig. 7

4.4 SETTING THE TIMER

The air filter can be set for a timed operation of 1, 2, or 4 hours. At the end of this time, the air filter will automatically turn OFF.

To cycle through the available time settings, press the TIME button on the remote control repeatedly.

This will illuminate the corresponding lights on the control panel. (Fig. 8)

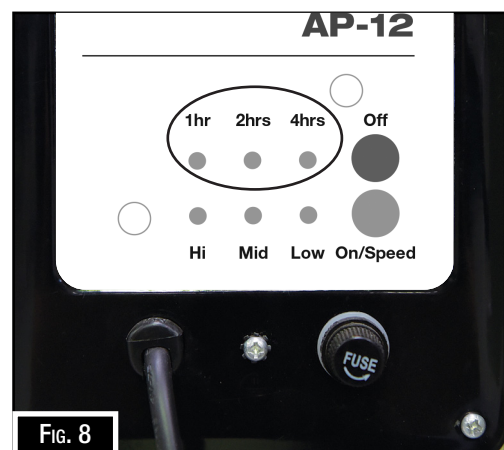

Fig. 8



WARNING!

When cleaning the cabinet or the filter, wear a respirator and safety goggles. Failure to comply can cause serious personal injury.

5. MAINTENANCE



WARNING Before maintaining or cleaning the machine, turn off the circuit breaker, or disconnect the machine from the power supply.

Post a sign to inform other workers that the machine is under maintenance.

For optimum performance from the machine, it is important that the machine is well cleaned and maintained. Follow the maintenance schedule listed in the following section and refer to any specific instructions given.

Check the filters approximately every 40 hours of use in light or moderately dusty environments. In very dusty environments, check the filters every eight hours of use. Always wear a respirator when checking the filter

5.1 TROUBLESHOOTING

Review the troubleshooting and procedures in this section if a problem develops with your machine. If you need replacement parts then follow the procedure in the beginning of the spare parts section or if additional help with a procedure is required, then contact your distributor.

Note: Make sure you have the model of the machine, serial number, and manufacture date before calling.

Symptom	Possible Cause	Possible Solution
Machine does not start or a breaker trips.	<ol style="list-style-type: none"> 1. Power supply switched OFF or is at fault. 2. Remote control not working or batteries are dead 3. Infrared transmission is blocked or remote too far away. 4. Wall circuit breaker tripped. 5. Control panel fuse blown. 6. Infrared receiver at fault. 7. Control panel ON SPEED button faulty. 8. Motor at fault. 	<ol style="list-style-type: none"> 1. Ensure power supply is ON and is the correct voltage. 2. Replace batteries; point remote control directly at the control panel. 3. Make sure the infrared receiver on the control panel is not blocked; try using the remote closer to the filter. 4. Ensure circuit breaker is correct or replace. 5. Check filters for blown fuse; replace. 6. Inspect/replace if faulty. 7. Replace faulty ON SPEED button. 8. Test/repair/replace.
Machine has vibration or noisy operation.	<ol style="list-style-type: none"> 1. Motor or component loose. 2. Motor fan rubbing on fan cover. 3. Motor bearings at fault. 	<ol style="list-style-type: none"> 1. Inspect/replace damaged bolts/nuts, and re-tighten with thread locking fluid. 2. Fix/replace fan cover; replace loose/damaged fan. 3. Test by rotating shaft; rotational grinding/loose shaft requires bearing replacement.
Loud, repetitious noise, or excessive vibration coming from air filter.	<ol style="list-style-type: none"> 1. Air filter is not mounted properly and wobbles. 2. Impeller fan is damaged, loose, or unbalanced. 3. The motor mounting is loose. 4. Motor fan housing is dented, causing the motor fan blade to hit the housing while spinning. 	<ol style="list-style-type: none"> 1. Stabilize the air filter. 2. Unplug air filter, and inspect the impeller for dents, bends, loose fins. Replace impeller if any damage is found. 3. Make sure all fasteners on the air filter are tight. 4. Replace motor fan housing.
Air filter does not adequately collect dust; poor performance.	<ol style="list-style-type: none"> 1. The filters are dirty. 	<ol style="list-style-type: none"> 1. Clean the filters

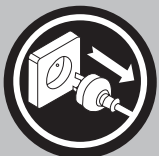

WARNING!
Always disconnect the power to the machine before servicing or doing maintenance to the machine.

5.2 CLEANING THE FILTERS

The amount of air filter operation has a direct bearing on when you must clean or replace the filters.

To maintain efficient operation, check the filters approximately every 40 hours of use in light or moderately dusty environments. In very dusty environments, check the filters every eight hours of use.

NOTE: Always wear a respirator when checking the filters.

To change the filters

1. DISCONNECT THE MACHINE FROM THE POWER SUPPLY.
2. Un-latch the filter retaining clips from the top and bottom of the unit, (Fig.9) and remove the outer filter. Place the filter in a trash bag and shake it gently to remove the bulk of the dust.

NOTE: If you choose to use compressed air to further clean the outer filter, do so outdoors and in an appropriate environment where people are not in the immediate vicinity.

3. Remove the inner filter, place it inside out and gently shake the dust from the inside of the filter over a trash can.

Optional: Wash the inner filter with water to remove the remaining dust, then let it air dry completely. DO NOT use compressed air on the inner filter

4. Re-install the inner filter, then re-install the outer filter with the wire mesh facing to the inside. (Fig. 11)
5. Re-latch the retaining clips to secure the filters.

NOTE: During regular use the filters can be cleaned several times before replacement becomes necessary.

To determine whether the filters need to be replaced, hold them up to the sunlight and visually inspect them. If you cannot see through the filters due to caked dust and grime, replace them before putting the air filter back into operation.

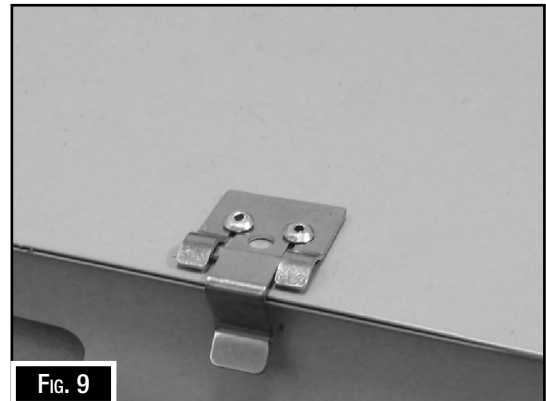

FIG. 9

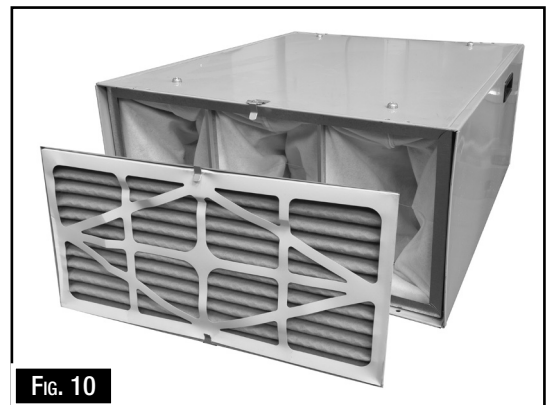

FIG. 10

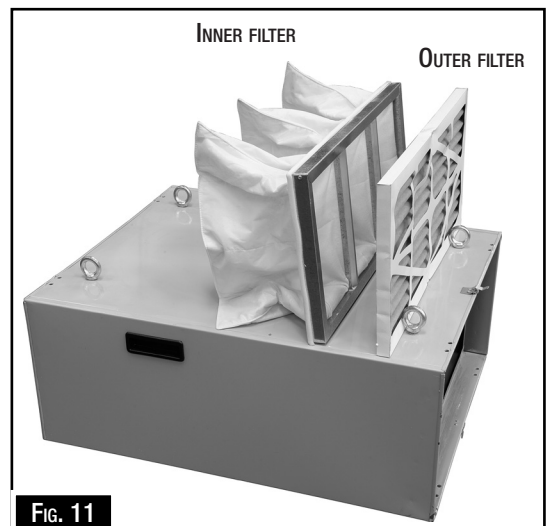

FIG. 11

5.3 FUSE REPLACEMENT

The fuse can be found on the front of the control panel and is designed to blow in the case of a thermal overload.

Replace the fuse only with a fast-acting, 5A, 250V fuse

To replace the machine fuse:

1. DISCONNECT THE MACHINE FROM THE POWER!
2. Loosen the fuse holder cap from the control panel (Fig. 9) and remove it. The fuse will come out with the fuse holder cap. (Fig. 12)
3. Replace the fuse and fully thread the cap in to secure it.



Fig. 12

5.4 REMOTE BATTERY CHANGE

The remote control uses two AA batteries. To replace them, slide the battery compartment cover down and off the remote (Fig. 10). Insert the batteries in the proper direction making sure the “+” and “-” are lined up with the markings on the remote and then replace the cover. (Fig. 13)

NOTE: Batteries not supplied



Fig. 13



CAUTION!

BEFORE EACH USE, inspect the general condition of the 3-SPEED AIR CLEANER. Check for loose screws, misalignment or binding of moving parts, cracked or broken parts, damaged electrical wiring, and any other condition that may affect its safe operation. If abnormal noise or vibration occurs, have the problem corrected before further use. Do not use damaged equipment.



WARNING!

Make sure the machine is turned OFF and the cord is disconnected from the power source before installing/removing and servicing any component of the machine.

AIR FILTRATION UNIT AP-12

Order Code: (W326)

Edition : 2.0
Date: (01/26)

The following section covers the spare parts diagrams and lists that were current at the time this manual was originally printed. Due to continuous improvements of the machine, changes may be made at anytime without notification.

HOW TO ORDER SPARE PARTS

1. Have your machines model number, serial number & date of manufacture on hand, these can be found on the specification plate mounted on the machine.
2. A scanned copy of your parts list/diagram with required spare part/s identified.

NOTE: SOME PARTS MAY ONLY BE AVAILABLE AS AN ASSEMBLY

3. Go to www.machineryhouse.com.au/contactus and fill out the inquiry form attaching a copy of scanned parts list.



WARNING!

*Electricity is dangerous and could cause death
All electrical work must be carried out by a qualified electrician.*



CAUTION!

It is impossible to cover all possible hazards Every workshop environment is different. These are designed as a guide to be used to compliment training and as a reminder to users prior to equipment use. Always consider safety first, as it applies to the individual working conditions.

SPARE PARTS DIAGRAM

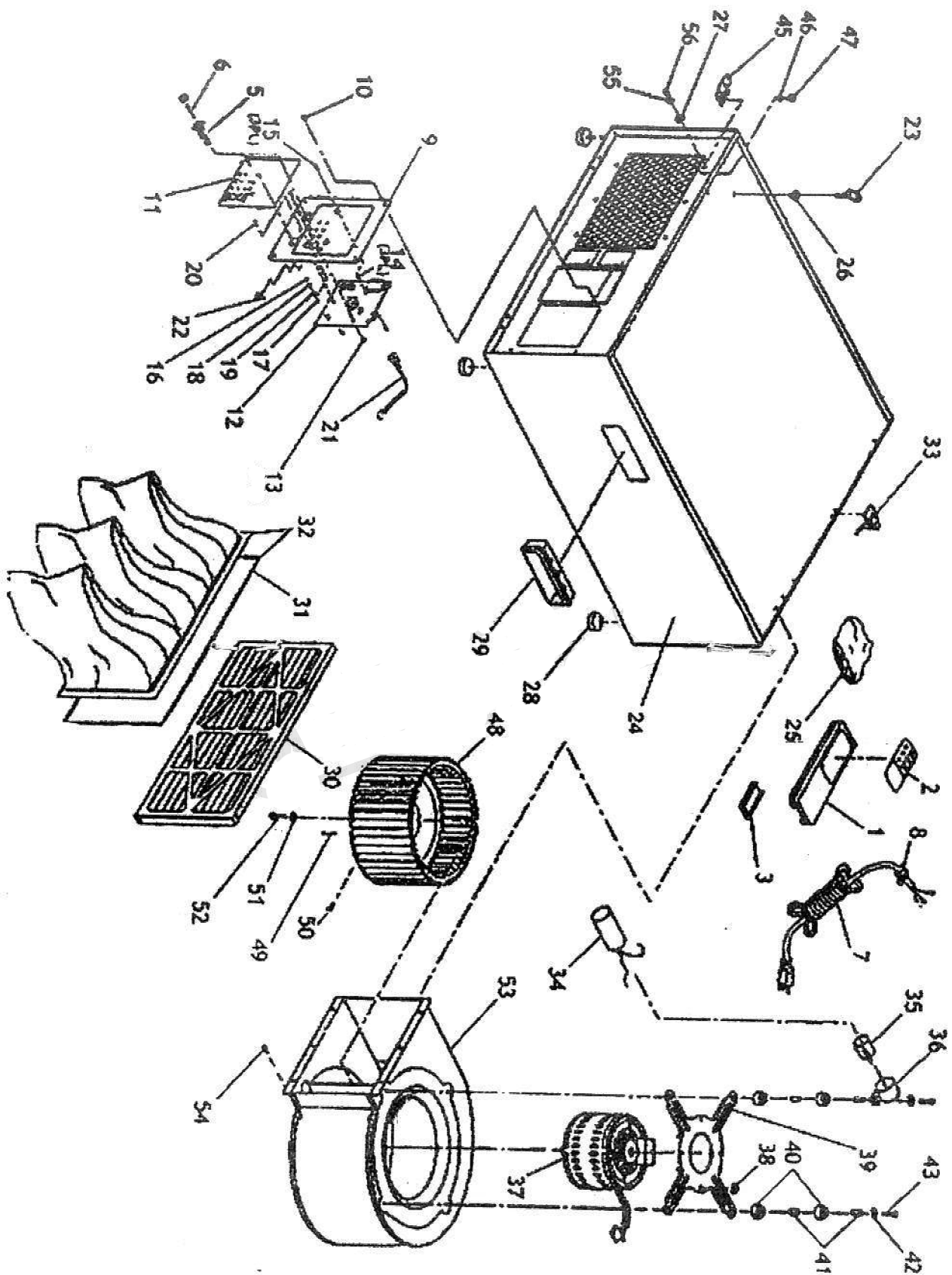

SPARE PARTS LIST

ITEM	DESCRIPTION	ITEM	DESCRIPTION
1	REMOTE CONTROL	33	CLIP SET
2	LABELS (CONTROLS)	34	CAPACITOR
3	REMOTE CONTROL COVER	35	INSULATOR
4	DELETED	36	CAPACITOR CLAMP
5	FUSE HOLDER	37	MOTOR
6	FUSE 5 AMP (250VAC)	38	HEX LOCKING NUT M5
7	POWER CORD 3-WIRE (18GA)	39	FLANGE
8	STRAIN RELIEF	40	SPACER
9	CONTROL PANEL	41	SLEEVE
10	PHILLIPS HEAD SCREW M4 X 10	42	FLAT WASHER M6
11	LABEL (CONTROLS)	43	HEX BOLT M6 X 30
12	PC BOARD	44	DELETED
13	PHILLIPS HEAD SCREW M3 X 6.5	45	FLANGE BRACKET
14	SPACER (SPECIAL)	46	FLAT WASHER M6
15	PHILLIPS HEAD SCREW (SPECIAL)	47	HEX BOLT M6 X 10
16	EXT TOOTH WASHER M4	48	FAN
17	HEX NUT M4	49	KEY 4 X 4 X 20
18	FLAT WASHER M4	50	HEX BOLT M8 X 12
19	LOCK WASHER M4	51	FLANGE DISC 6.5 X 44MM
20	PHILLIPS HEAD SCREW M4 X 6	52	CAP SCREW M6 X 20 (LH)
21	PC WIRING HARNESS	53	FAN HOUSING
22	BOLT (SPECIAL) M3 X 6.5	54	TAPPING SCREW
23	EYE BOLT M6 X 20	55	LOCK WASHER
24	HOUSING	56	PHILLIPS HEAD SCREW M6 X 16
25	MOUNT AND BOLT BAG		
26	RIVET NUT M6 X 8		
27	FLAT WASHER 6MM		
28	RUBBER FOOT		
29	HANDLE		
30	PRIMARY FILTER 5-MICRON		
31	FOAM SEAL 1/4" X 1" X 70"		
32	SECONDARY FILTER 1-MICRON		

NOTE: SOME INDIVIDUAL PARTS MAY ONLY BE AVAILABLE AS AN ASSEMBLY



ENVIRONMENT PROTECTION

Recycle unwanted materials instead of disposing of them as waste. All tools, accessories and packaging should be sorted, taken to a recycling centre and disposed of in a manner which is compatible with the environment. When the product becomes completely unserviceable and requires disposal, drain any fluids (if applicable) into approved containers and dispose of the product and fluids according to local regulations.

IMPORTED BY

HARE & FORBES
MACHINERYHOUSE

Australian Distributor

Hare & Forbes
Machineryhouse
Sydney - Melbourne
Adelaide - Brisbane - Perth

Ph: 1300 202 200
www.machineryhouse.com.au

MACHINERYHOUSE

New Zealand Distributor

Machineryhouse
Auckland
Christchurch

Ph: 0800 142 326
www.machineryhouse.co.nz